

- 1 Enter administrative mode
- 2 + + press simultaneously
- 3 To change setting, choose with or "selection buttons"
- 4 Press to select "OK"
- 5 or change setting
- 6 Press to confirm "OK"
- 7 Press to exit settings "Back"

Switch off

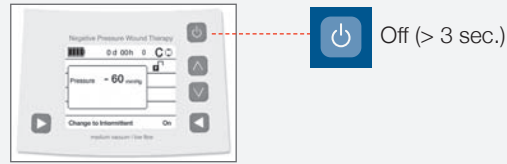

Basic double key functions

	Administrative	Patient
Administrative mode	Press and hold Press	
Change pressure	or Change pressure	
Log file	+ press simultaneously	Alarm data + press simultaneously
Change setting	+ press simultaneously	

Change Canister

- 1 Clamp patient tubing
- 2 > 3 Sec.
- 3
- 4
- 5
- 6
- 7 If necessary, replace tubing
- 8 On
- 9 Unclamp tubing

© Medela, Inc. 1908021 B 0109



Invia® Liberty™

Negative Pressure Wound Therapy



Quick Card

USA
Medela, Inc., P.O. Box 660, McHenry, IL 60051
Phone 877-694-6842, Fax 815-363-2487
myinvia@medela.com, www.medela.com



Precious life. Progressive care.®

Enter administrative mode

Switch on

- 1** 1. Press and hold 2. On
- 2 Acknowledge disclaimer**
- 3** New patient Same patient
- 4 Standby Mode** Therapy number Therapy time

Constant mode Intermittent mode

All further instructions will be the same for constant and intermittent mode

Change Pressure

- 1**
- 2** or change pressure
- 3** OK

Log file

- 1**
- 2** + press simultaneously
- 3** Graph mode

Warnings and Alarms

Warning
(Operation continues)

beep

Alarm
(Operation stops)

beep beep beep

1 Problem description on the display

Example:

2 Acknowledge acoustic alarm 60 Sec.

3 Troubleshooting on the display

Fault number

	Fault number	Problem description on the display	Troubleshooting on the display	Remarks/potential cause of fault	Pressure
Alarm	301	Leak in system	Check system for leaks	<ul style="list-style-type: none"> • Tubing not secured • Missing or defective seal between the canister and Invia Liberty • Dressing not sealed properly 	✗
	302	System clogged	<ul style="list-style-type: none"> • Check that tubing is clear/not twisted • Check canister filling level 	<ul style="list-style-type: none"> • Tubing is kinked or clogged • Filter in canister contaminated 	✗
	305	Battery empty	Charge battery		✗
	306	Canister full	Change canister	Pressure is maintained if Invia Liberty is in upright position	✓
Warning	401	Battery low	Charge battery	Remaining time of battery approx. 30 min.	✓
	402	USB connection not permitted	Unplug USB cable	USB connection during operation not permitted	✓
	405	Standby mode	Switch on or off	In standby mode after 5 minutes	✓

✗ Operation stops ✓ Operation continues